

# HYDROSCRUB™ 200

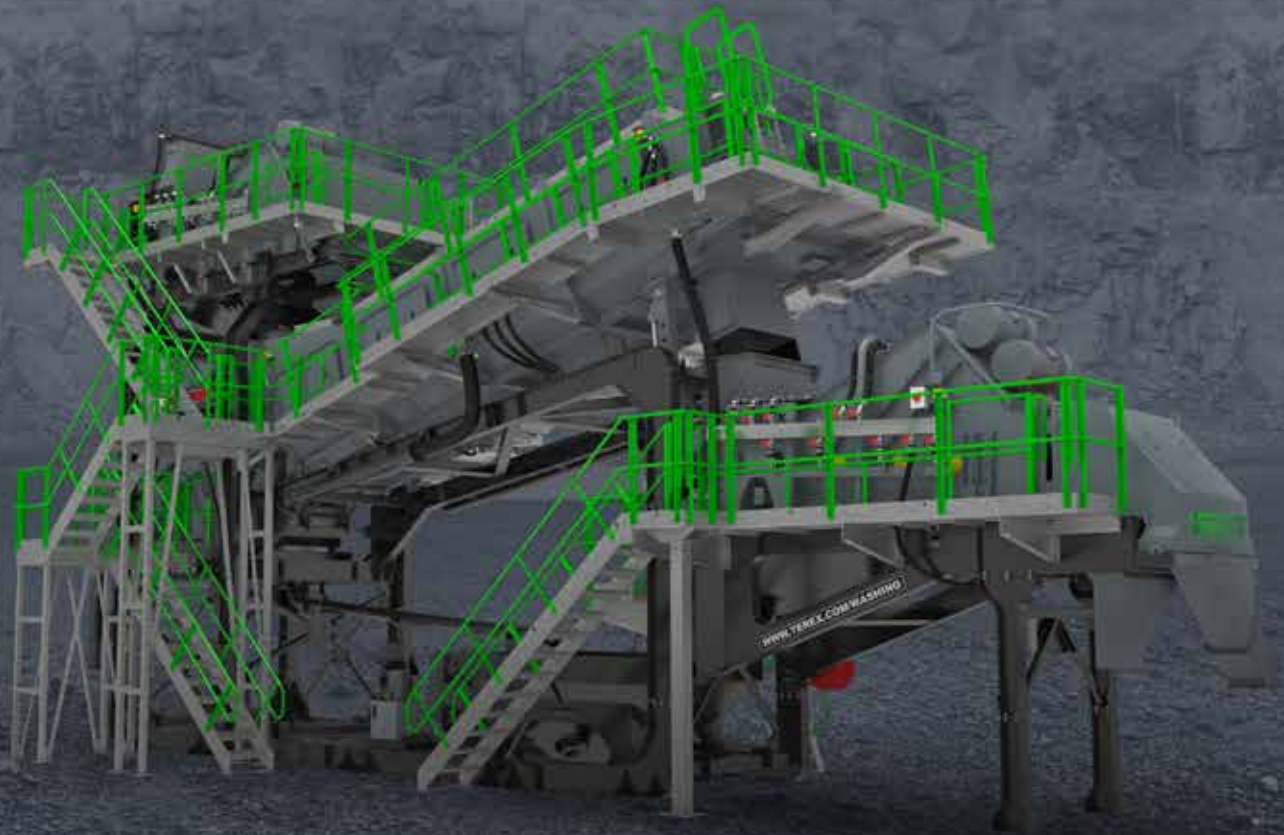

The HydroScrub™ 200 Rinsing, scrubbing, separating and sizing on one small footprint.

AGGREGATES 

RECYCLING 

INDUSTRIAL SANDS 

MINING 

The Terex Washing Systems HydroScrub™ 200 has been specifically engineered to work in wash recycling applications. The HydroScrub™ Hull forms the core of the machine, and can easily be adjusted to work in Logwasher or HydroScrub™ mode, thus offering the operator maximum flexibility to optimise the machine performance. From upward hydro-injection, to variable speed logs, the HydroScrub™ offers many intelligent features that allow the operator to process a wide range of feed materials, from difficult to scrub conglomerated aggregates and clays, to aggregate that are heavily laden with light contaminants such as organics, plastics and wood.

Neatly packaged on a modular chassis, the HydroScrub™ 200 utilises an on-board full rinsing 2-Deck Pre-Screen, 2-Deck aggregate sizing screen, high capacity trash screen & single central collection sump. All round walkway access and multiple maintenance hatches complete an easy to operate, easy to maintain complete rinsing, scrubbing and sizing solution.



Advanced fully automated control with remote communication

HydroScrub™ 200 hull

Patented rolling chute technology

2 deck 12' x 5' (3.7m x 1.5m) full rinsing pre-screen, Optional operating angles, high clearance bridge

Integrated wash box with high volume water manifold

Fully plumbed and wired

Hull clean out to trash screen

8' x 4' (2.4m x 1.2m) Trash screen

2 Connection points, high pressure and low pressure inlets

Unprecedented complete access around plant with galvanised walkways, access stairs and handrails

2 deck 12' x 5' (3.7m x 1.5m) aggregate screen, capable of producing 4 products, full or part rinser

Integral sump tank and pump for collection and removal of dirty water

Key operated powerpack for hydraulic angle adjustment

# HYDROSCRUB™ 200

## APPLICATIONS

The HydroScrub™ 200 can process up to seven products in the following applications:

- Natural aggregates & Ores
- Crushing & Demolition
- Site Excavation Waste
- Muck Away
- Railway Ballast
- Road Sweepings/Skip Waste
- Contaminated Aggregate Waste

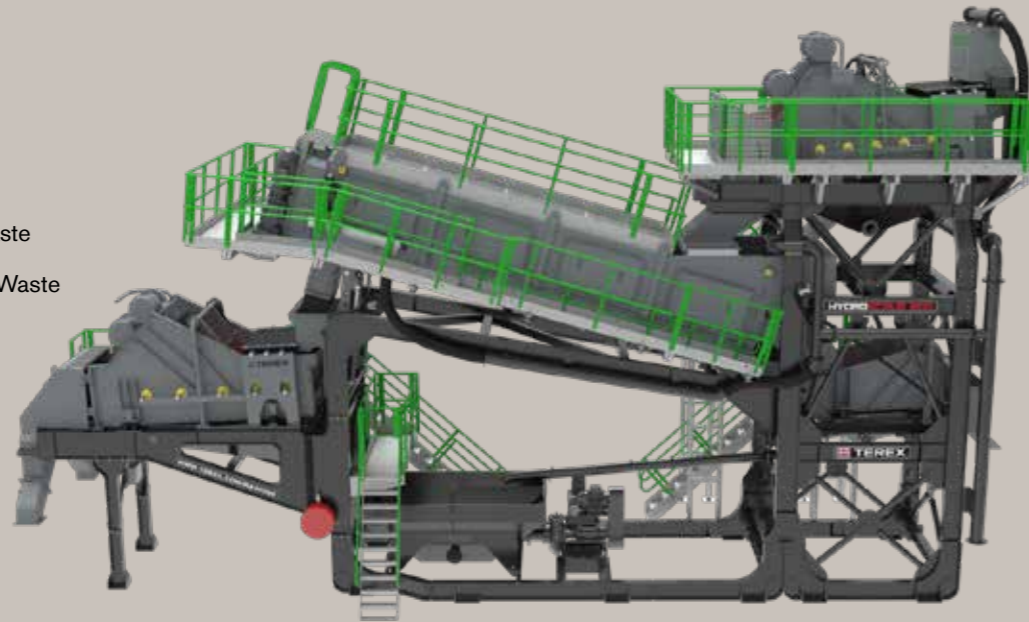

## COMPONENTS

The HydroScrub™ 200 has the following features:

### Pre-Screen

- High frequency vibrating screen
- 2 deck 12 x 5 full rinser
- Independent spray bars
- Optional operating angle Horizontal to negative 3°
- Washes off fine material, single or double grade

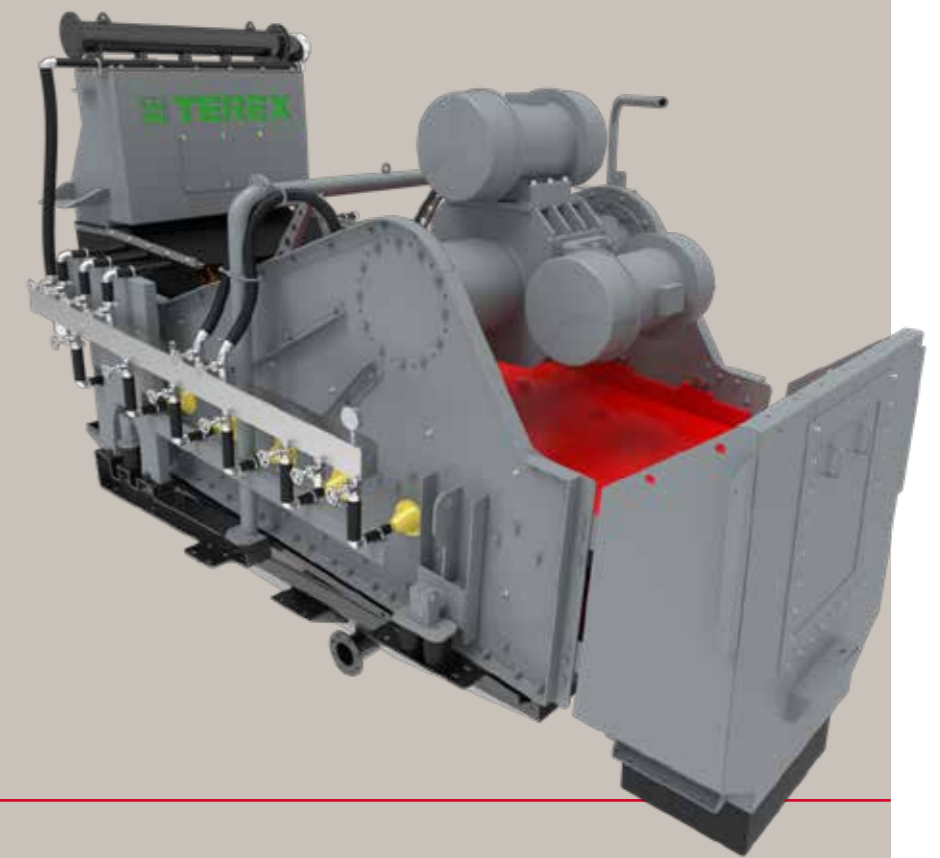

### HydroScrub™ 200 Hull

- 7.5m long x 2.4m wide (45 x 24)
- 2 x 45kw motors, control retention time using Variable speed drives
- Hydraulic angle adjustment from 10 - 16°, works effectively as a log washer, or in HydroScrub™ mode
- Simple switchover between modes, close lower weir, raise the angle
- Quick access side and rear clean out doors
- Hub and key mounted drive gears for ease of maintenance
- Robust log design with reinforced leading edge protection and weld on wear protection strips
- Flexible configurations of Hardox Screw flights, hammers and square blades. These can be used in combination to ensure optimum performance

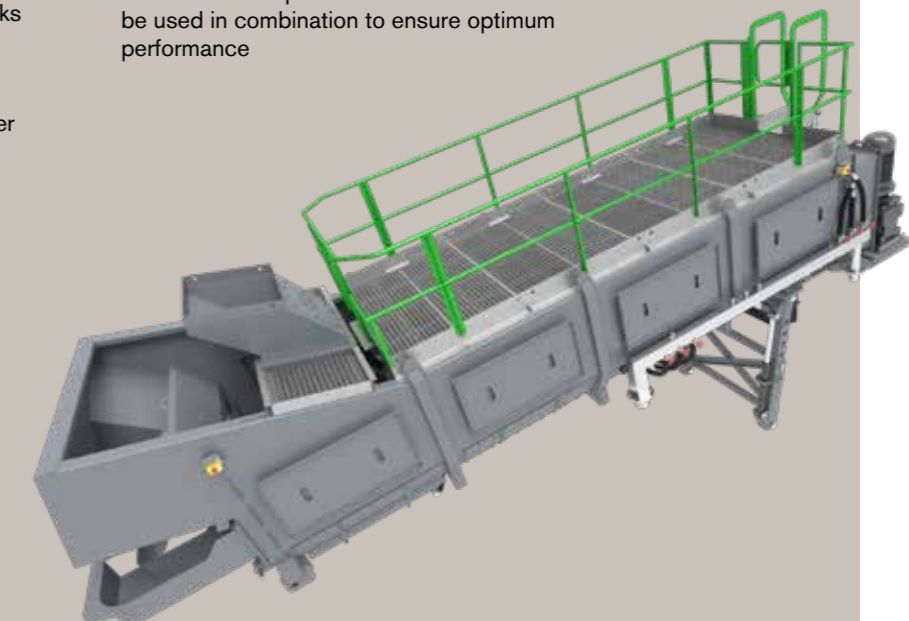
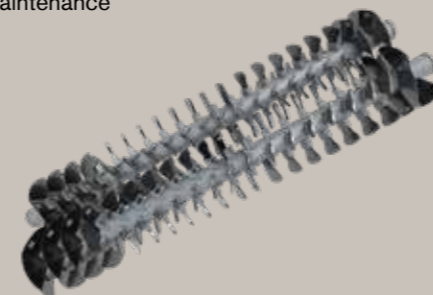

## OPTIONS

The HydroScrub™ 200 can be offered with the following options:

- Horizontal oversize reject conveyor
- Upgrade to 16 x 5 3d horizontal sizing screen
- Sump tank upgrade to Conical Classifying tank
- Flood lighting
- Wash down hose reel



# HYDROSCRUB™ 200

## COMPONENTS

### Chassis

- Heavy duty steel construction
- Webframe modular chassis
- Bolt together construction for ease of transport
- Easy access to serviceable areas

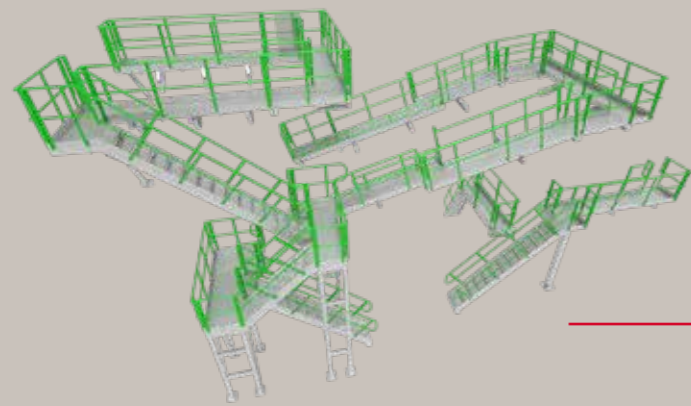
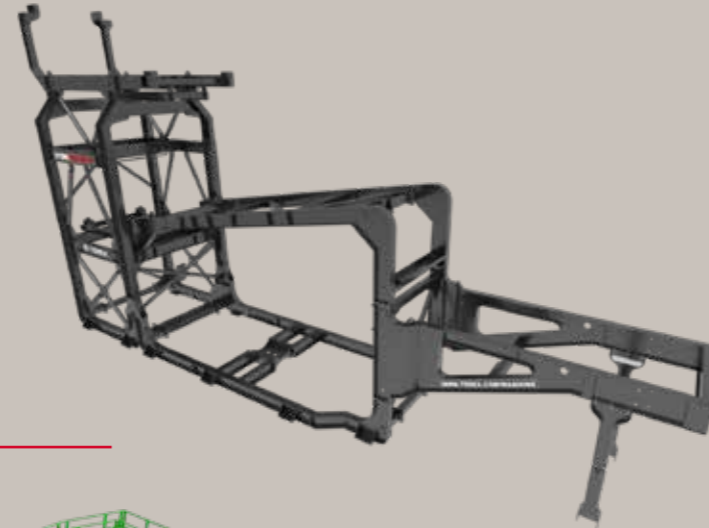

### Access

- Fully galvanized
- Ergonomic design
- Optional expanded metal or G.R.P flooring

### Trash screen

- Exceptional dewatering performance
- 2 x vibratory motors
- Polyurethane modules and side protection
- Polyurethane low friction chute liners

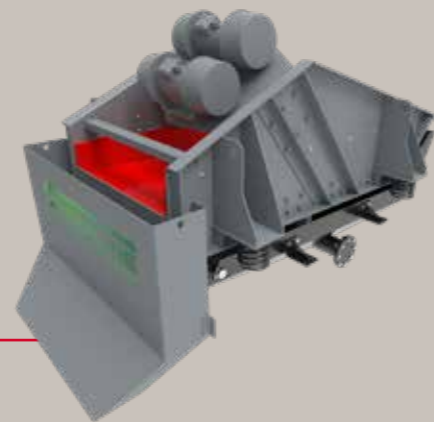

### Post screen

- High frequency vibrating screen
- Independent spray bars
- Rinsing and grading of up to 4 products
- Washes off any fines after scrubbing

## TRANSPORT

The HydroScrub™ 200 is designed to fit standard shipping containers in the most cost effective way:

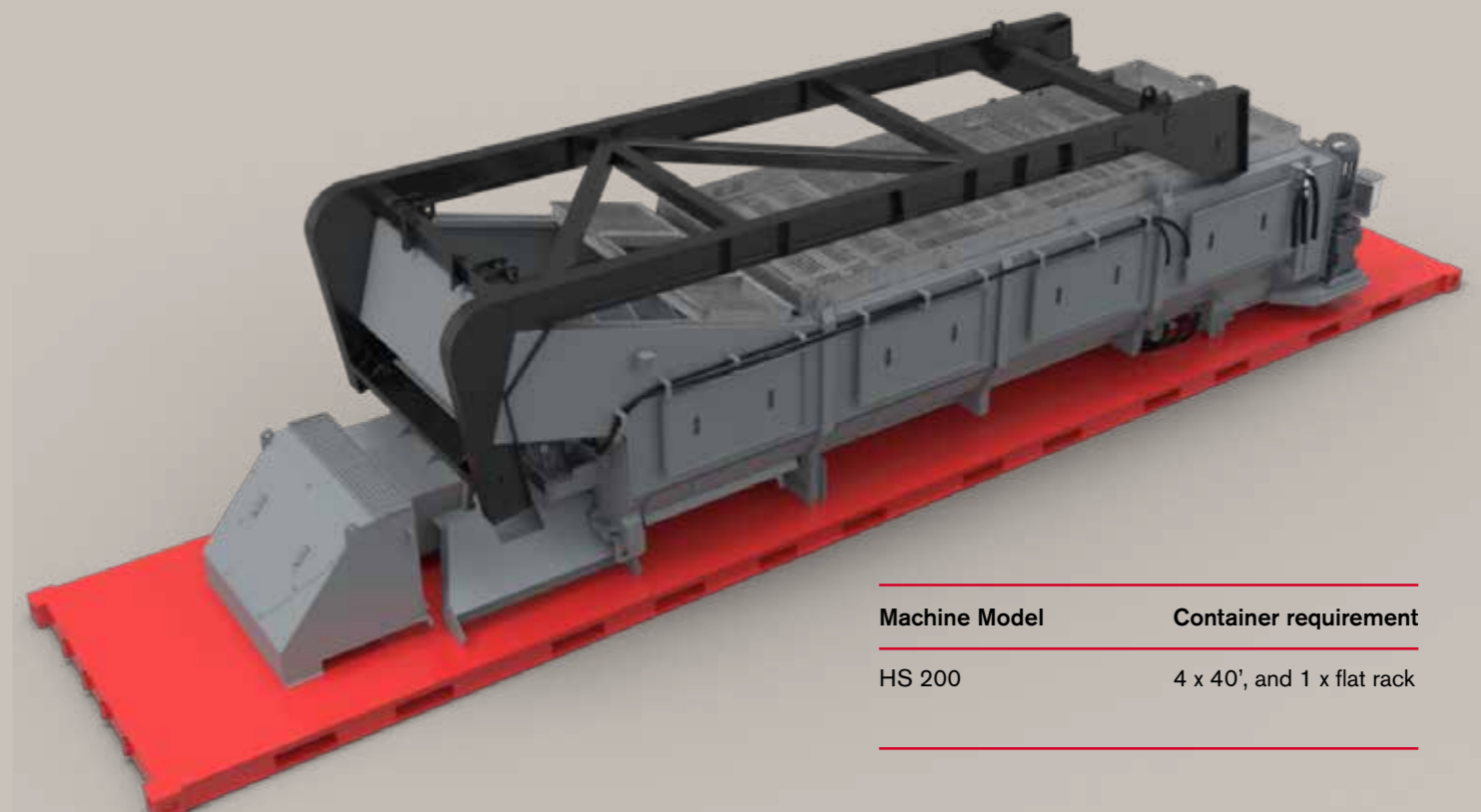
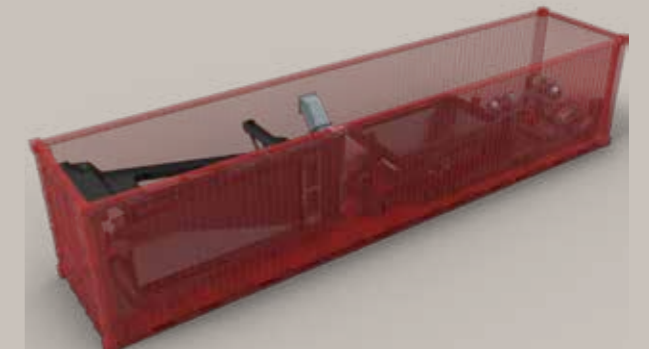
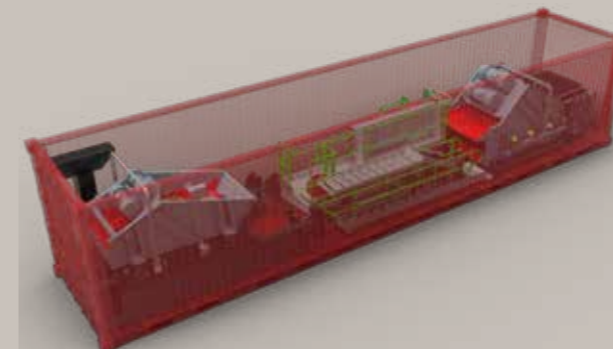
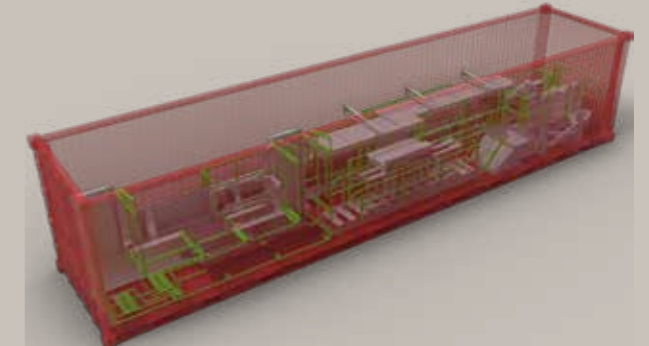
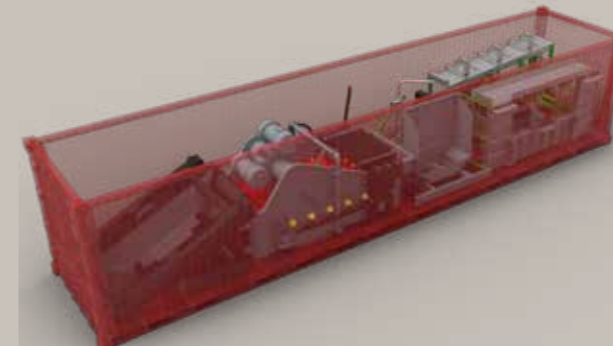

Machine Model	Container requirement
HS 200	4 x 40', and 1 x flat rack

# HYDROSCRUB™ 200

## TECHNICAL SPECIFICATION



Machine Model	HS 200	Power requirement (kW [hp])
Hull Throughput (tph)	Up to 200 tph	90 [120]
Pre-screen Screen (m [ft])	3.7m x 1.5m [12' x 5']	8 [10]
Trash Screen (m [ft])	2.4m x 1.2m [8' x 4']	4 [5]
Post Screen (m [ft])	3.7m x 1.5m [12' x 5']	8 [10]
Sump Volume	4.7m <sup>3</sup>	-
Pump Size (mm)	200/150	-
Pump Power (kW [hp])	15 [20]	15 [20]
Inlet Flange (mm [Inch])	200 [8] low pressure supply 150 [6] high pressure supply	-
Outlet Flange (mm [Inch])	200 [8]	-
Total Power (kW [hp])	-	125 [165]

## DIMENSIONS

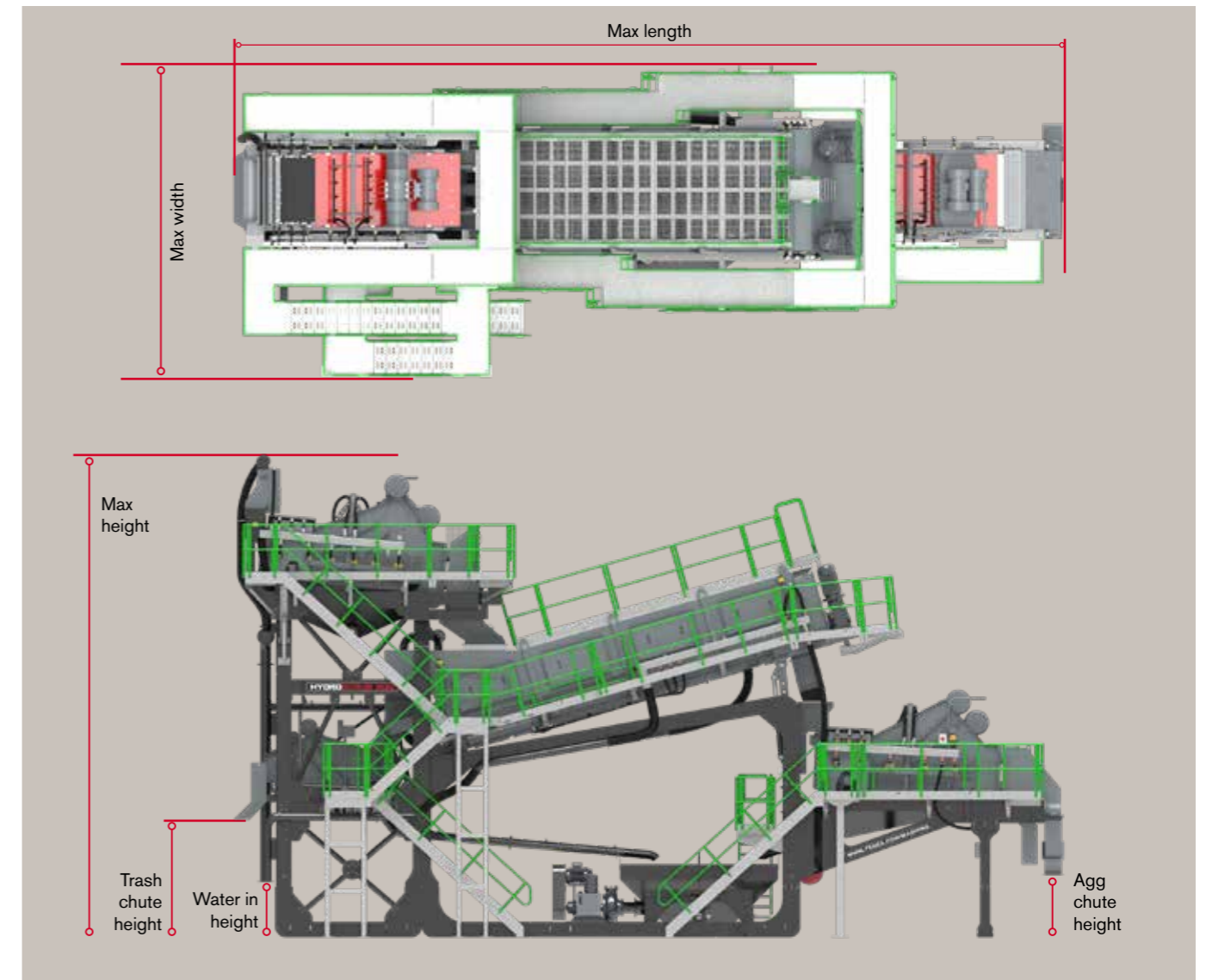

Machine Model	HS 200
Max height	9780 [32'1"]
Max length	16823 [55'2"]
Max width	6191 [20'4"]
Water Inlet height	1100 [3'7"]
Trash chute height	2400 [7'10"]
Agg chute height	1225 [4'1"]

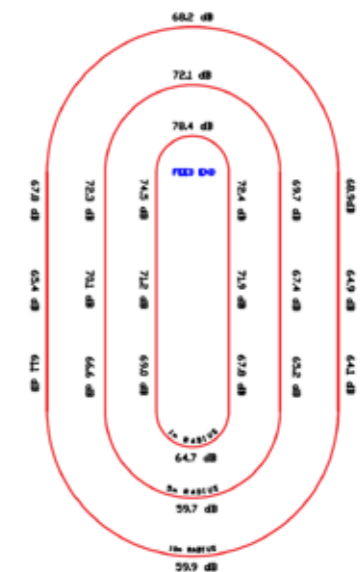



**WASHING SYSTEMS**

**WASHING AS IT SHOULD BE**



CHECK OUT TEREX WASHING SYSTEMS  
VIDEOS ON YOUTUBE:

[www.youtube.com/terexwashingsystems](http://www.youtube.com/terexwashingsystems)

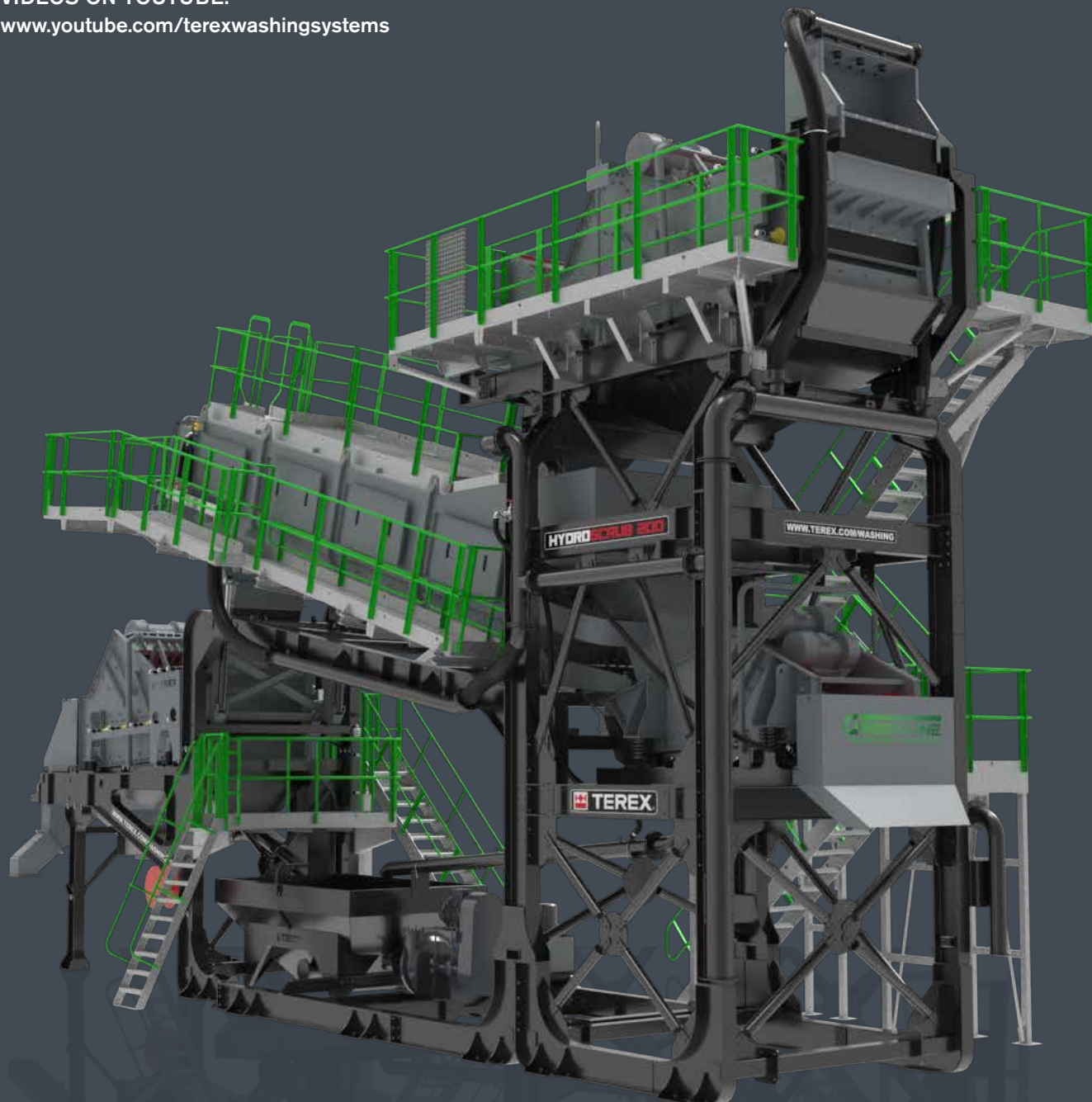

## **TEREX WASHING SYSTEMS**

### **FARLOUGH SITE**

32 Farlough Road,  
Dungannon,  
Co. Tyrone,  
Northern Ireland, BT71 4DT

Tel: +44(0) 28 8771 8500  
Email: [TWS.sales@terex.com](mailto:TWS.sales@terex.com)

[www.terex.com/washing](http://www.terex.com/washing)

Effective Date: October 2020 Product specifications and prices are subject to change without notice or obligation. The photographs and/or drawings in this document are for illustrative purposes only. Refer to the appropriate Operator's Manual for instructions on the proper use of this equipment. Failure to follow the appropriate Operator's Manual when using our equipment or to otherwise act irresponsibly may result in serious injury or death. The only warranty applicable to our equipment is the standard written warranty applicable to the particular product and sale and Terex makes no other warranty, express or implied. Products and services listed may be trademarks, service marks, or trade names of Terex Corporation and/or its subsidiaries in the USA and other countries. All rights are reserved. Terex is a registered trademark of Terex Corporation in the USA and many other countries.  
© 2020 Terex Corporation.